



D1517/780 Bourke Street Redfern NSW

1 1 1

Positioned on the 15th floor of the glamorous 'Dowling' building in the upmarket Moore Park Gardens, this split-level one bedroom unit is backdropped by spectacular 180 degree Northerly views towards the City skyline. Beautiful by day, a magical fairyland of lights by night, this unit really is a stand-out and gazes out over the trees and Golf Course to the City. Available to move into now, imagine your first New Year's Eve partaking of our famous fireworks from your own living room.

View : <https://www.shearerproperty.com.au/lease/nsw/eastern-suburbs/redfern/residential/apartment/6691550>

- ? Freshly painted and new light fittings throughout
- ? Spacious open plan living and dining area
- ? Living flows to large covered balcony for year-round use
- ? Contemporary modern kitchen in taupe tones with dishwasher, Smeg gas cooktop
- ? Fully upgraded bathroom with separate bath and shower and excellent storage



Luke Mavromatis
02 9310 1801

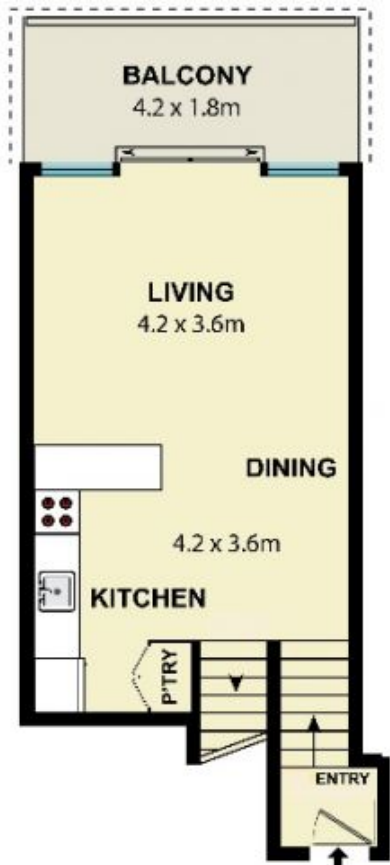

Level 15



Lower Level

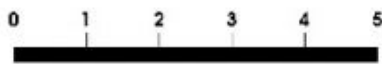

SCALE (METRES)

D1517/780 Bourke Street, Redfern

Scale in metres. Indicative only. Dimensions are approximate. All information contained here in is gathered from sources we believe to be reliable. However we cannot guarantee its accuracy and interested persons should rely on their own enquiries.