



31/189 Phillip Street Waterloo NSW

1 1

This well laid out studio is located within a well maintained block and has great natural light with its east facing direction.

- *Spacious living, dining and bedroom area
- *Generous built-in wardrobe
- *Full kitchen with lots of storage
- *Tidy bathroom with bath tub
- *Security building with lift access
- *Undercover secure parking
- *Outdoor swimming pool and BBQ area
- *Bus at door step

The property is well positioned being close to the CBD and hip Surry Hills, walking distance to Centennial Parklands and the Entertainment Quarter and around the corner from the local supermarkets and popular Danks Street cafes and

View : <https://www.shearerproperty.com.au/sale/nsw/eastern-suburbs/waterloo/residential/studio/5823637>



Sue Shearer
02 9310 1801

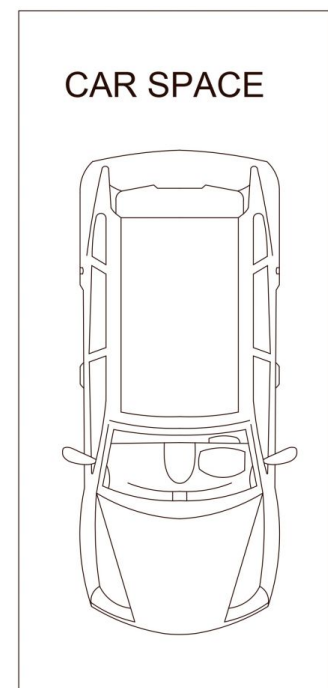
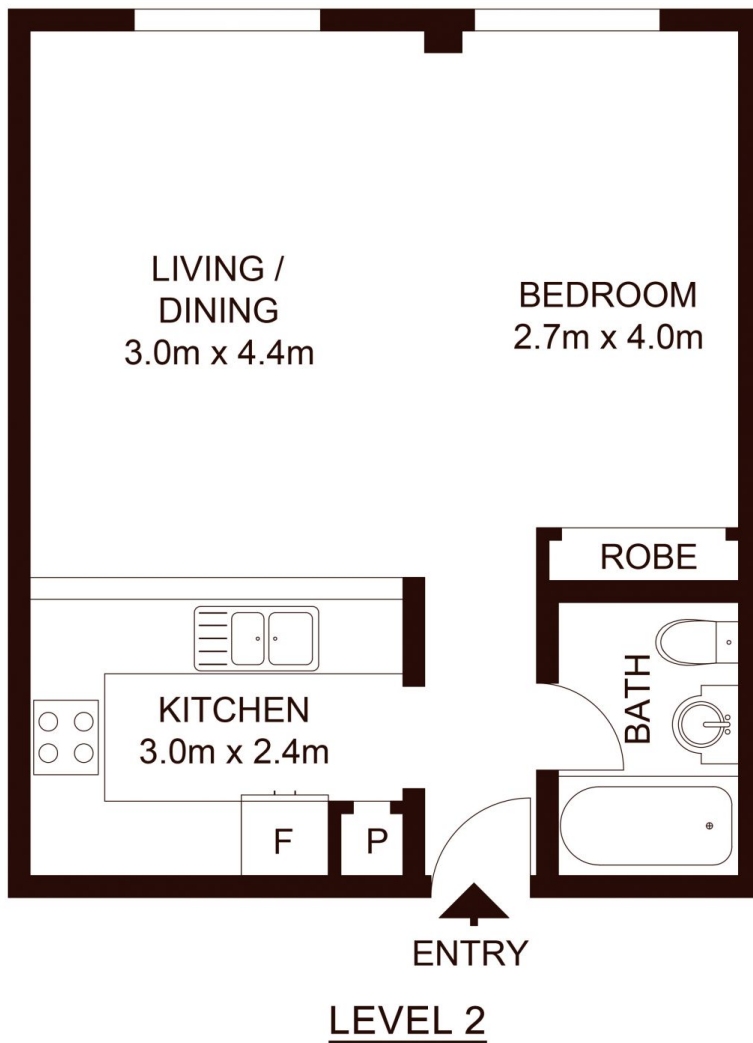

Scale shown in metres. All dimensions herein are approximate and gathered from sources believed to be reliable. Whilst every effort is made for the accuracy of our floor plans, interested parties should rely on their own enquires. Floor Plans by Industrie Media. www.industriemedia.com.au



31/189 Phillip Street, Waterloo

shearer
property