



A501/780 Bourke Street Redfern NSW

1 1 1

Spacious and impressively well proportioned, this superior one bedroom apartment occupies a peaceful and elevated setting in the Argyle building of Moore Park Gardens. With a generous 89sqm floor area, this property epitomizes low maintenance modern living at it's best. An exceptional investment, or prime opportunity for the professional couple to enter a prestige market.

With an integrated Caesar Stone kitchen including a dishwasher and gas cooking, additional features include an entertaining balcony, open plan living, secure parking, and resort style facilities including, a pool, gym, and sauna. An award winning community, it is no more than a stroll to Danks Street and Crown Street culinary culture.

- Modern kitchen with Caesar Stone bench tops, dishwasher and gas cooking

Land Size : 89 sqm
View : <https://www.shearerproperty.com.au/sale/nsw/eastern-suburbs/redfern/residential/apartment/5823587>



Sue Shearer
02 9310 1801

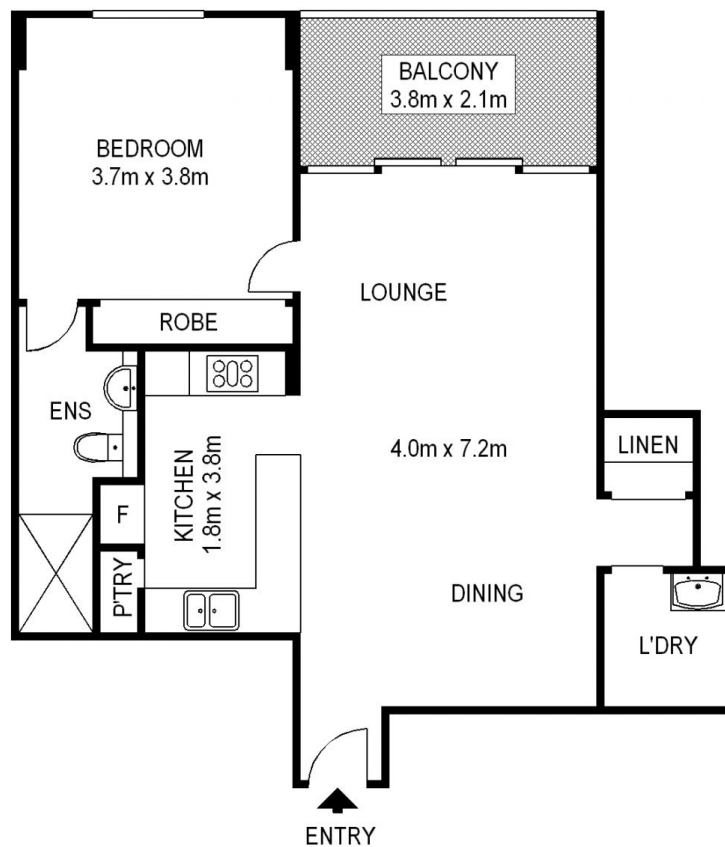
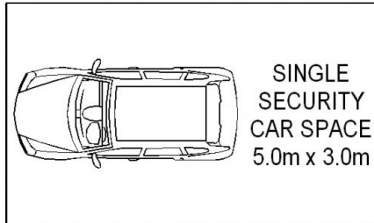

Scale shown in metres. All dimensions herein are approximate and gathered from sources believed to be reliable. Whilst every effort is made for the accuracy of our floor plans, interested parties should rely on their own enquires. Floor Plans by Industrie Media. www.industriemedia.com.au



A501/780 Bourke Street, Redfern

shearer
property