



G1504/780 Bourke Street Redfern NSW

2 2 1

Located in the Grosvenor building of the popular Moore Park Gardens complex, this two bedroom split level apartment with ideal north south aspect offers open plan living and dining flowing through to the large balcony boasting amazing city views.

A lifestyle of convenience close to the CBD, this apartment will be sure to impress .

Features Include:

- 2 Bedrooms, both with built in robes
- Main bedroom complete with ensuite
- Conveniently sized kitchen with gas cooking
- Spacious open plan living and dining
- Large balcony with amazing city views
- 123sqm including car space
- Security building with on site building management and security

Land Size : 123 sqm

View : <https://www.shearerproperty.com.au/sale/nsw/eastern-suburbs/redfern/residential/apartment/5823559>



Sue Shearer
02 9310 1801

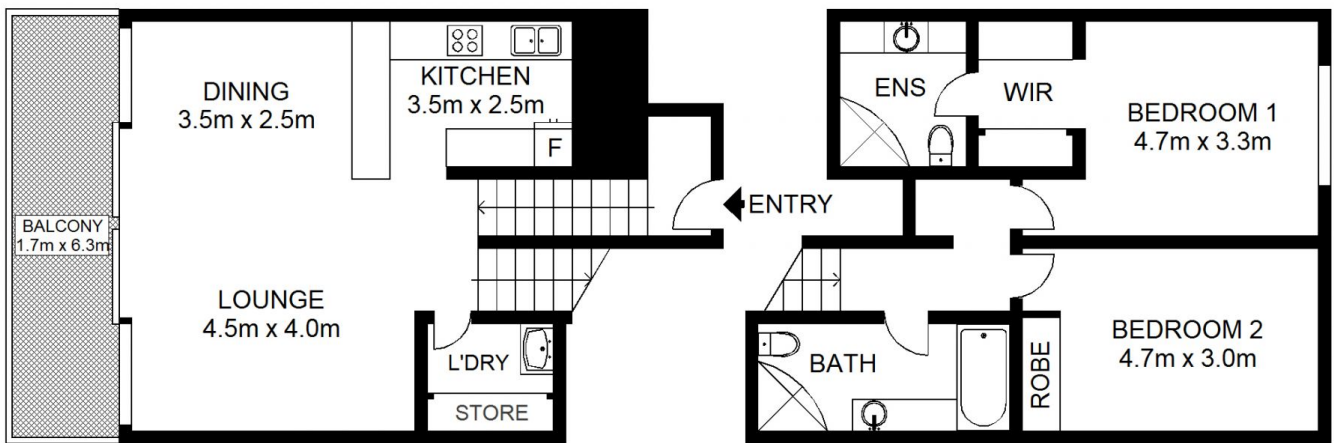

LEVEL ONE

LEVEL TWO

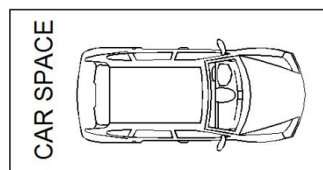

Scale shown in metres. All dimensions herein are approximate and gathered from sources believed to be reliable. Whilst every effort is made for the accuracy of our floor plans, interested parties should rely on their own enquiries. Floor Plans by Industrie Media | industriemedia.tv

S1

G1504/780 Bourke Street, Redfern

shearer
property