



503/320 Harris Street Pyrmont NSW

1 1 1

Situated in the popular MCentral building, this north facing apartment promises an inner city lifestyle of unmatched convenience. Also offering a separate study area which is ideal for a small 2nd guest bedroom plus car parking on same level as apartment.

Land Size : 82 sqm
View : <https://www.shearerproperty.com.au/sale/nsw/sydney-city/pyrmont/residential/apartment/5823551>

Features Include:

- Polished floorboards and high ceilings in true warehouse conversion style
- 82 square metres (including parking)
- Study/2nd small bedroom
- Gourmet kitchen including dishwasher, microwave and gas cooking



Sue Shearer
02 9310 1801

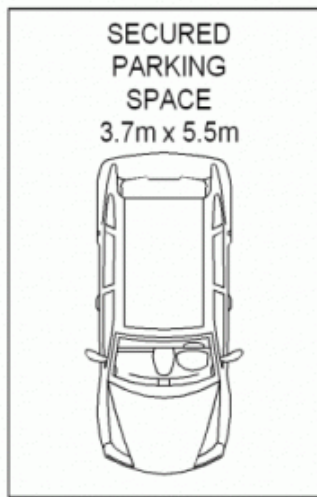

LEVEL FIVE

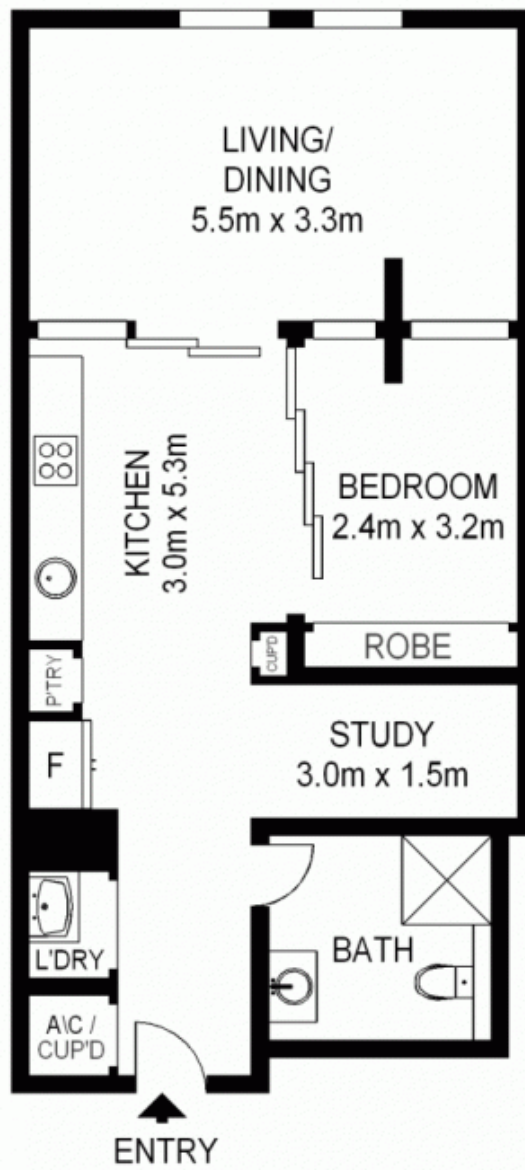

LEVEL FIVE



Scale shown in metres. All dimensions herein are approximate and gathered from sources believed to be reliable. Whilst every effort is made for the accuracy of our floor plans, interested parties should rely on their own enquiries. Floor Plans by Industrie Media | industriemedia.tv

S1

503/320 Harris Street, Pyrmont

shearer
property