

**511/380 Harris Street Pyrmont NSW**

1 1 1

Situated in the popular MCentral building, this most spacious (91 sqm) apartment plus parking promises an inner city lifestyle of unmatched convenience. This loft style apartment also has a 2nd guest bathroom PLUS a separate study area which is ideal for a small 2nd guest bedroom.

**View** : <https://www.shearerproperty.com.au/sale/nsw/sydney-city/pyrmont/residential/apartment/5823519>

Features include:

- . Polished Floorboards & high ceiling in true warehouse conversion style
- . Study/2nd small bedroom
- . 2nd guest bathroom
- . Gourmet kitchen including dishwasher, microwave and gas cooking
- . Large Master bedroom
- . Fabulous brick features
- . Airconditioning



**Sue Shearer**  
**02 9310 1801**

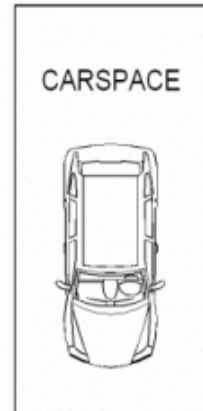
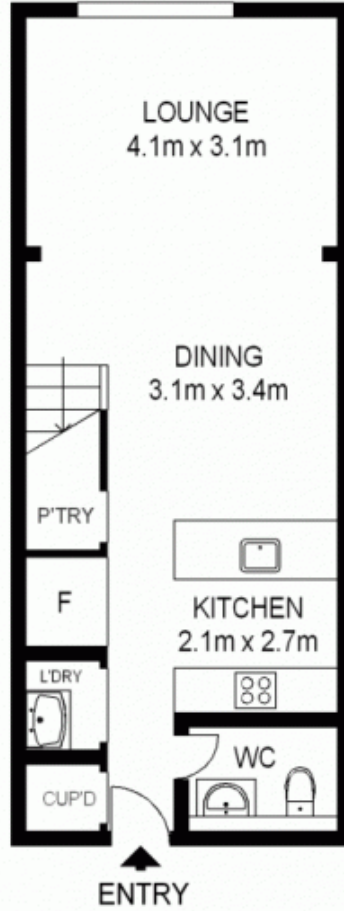

Scale shown in metres. All dimensions herein are approximate and gathered from sources believed to be reliable. Whilst every effort is made for the accuracy of our floor plans, interested parties should rely on their own enquiries. Floor Plans by Industrie Media | [industriemedia.tv](http://industriemedia.tv)

S1

511/380 Harris Street, Pyrmont

**shearer**  
property