



103/320 Harris Street Pyrmont NSW

1 1 1

Situated within the sought after M Central building, this superb development offers modern inner city apartment living with unique architectural features.

View : <https://www.shearerproperty.com.au/sale/nsw/sydney-city/pyrmont/residential/apartment/5823430>

- One bedroom with built in robes
- Separate study
- High ceilings in true warehouse conversion style
- Gourmet kitchen including dishwasher, oven and gas cook top
- Ducted reverse cycle Air-conditioning
- Internal laundry & secure car space
- Total area approx 82sqm including car space
- Secure car space



Sue Shearer
02 9310 1801

MCentral is conveniently connected to the hub of darling Harbour via a covered walkway and minutes to the heart of the CBD. A commute to work to be envied!

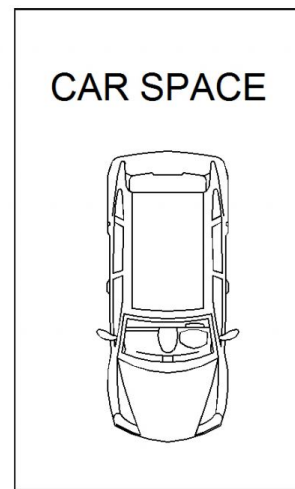
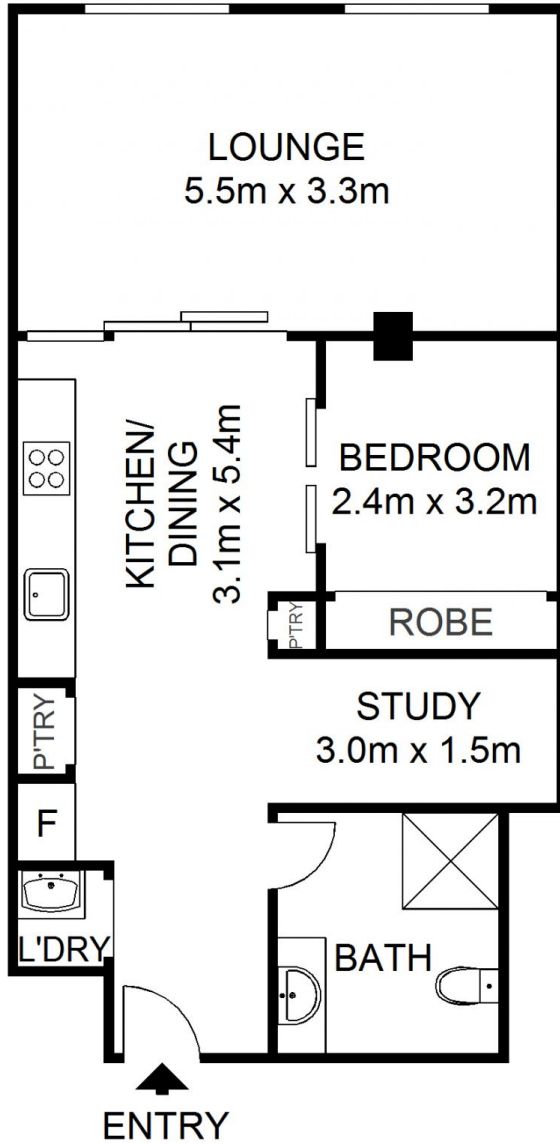

Scale shown in metres. All dimensions herein are approximate and gathered from sources believed to be reliable. Whilst every effort is made for the accuracy of our floor plans, interested parties should rely on their own enquiries. Floor Plans by Industrie Media | industriemedia.tv

S1

103/320 Harris Street, Pyrmont

shearer
property