



**513/380 Harris Street Pyrmont NSW**

2 2 1

Situated in the popular MCentral building this two bedroom 2 story apartment, promises an inner city lifestyle of unmatched convenience.

**View :** <https://www.shearerproperty.com.au/sale/nsw/sydney-city/pyrmont/residential/apartment/5823408>

Features include:

- Master bedroom with walk in robe
- Open plan living/dining area with polished floor boards
- Private courtyard
- Bathroom located on both level one and two
- Total area approx 113sqm including car space
- Gourmet kitchen with caesar stone benches including gas cook top
- Security parking on the same level
- Building Manager and Security on Site
- Award winning roof top garden area (common)



**Sue Shearer**  
02 9310 1801

MCentral is conveniently connected to the hub of Darling

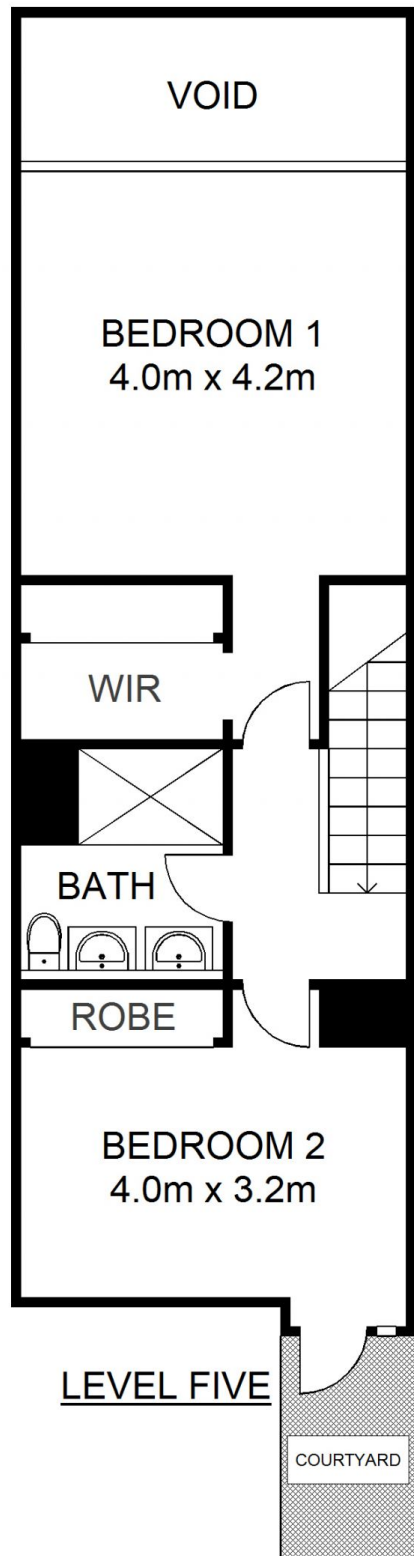
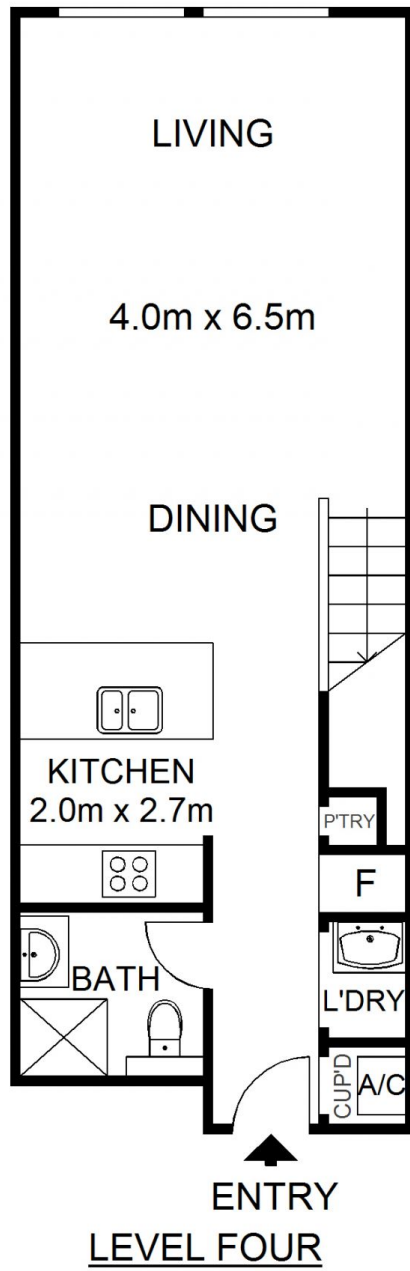
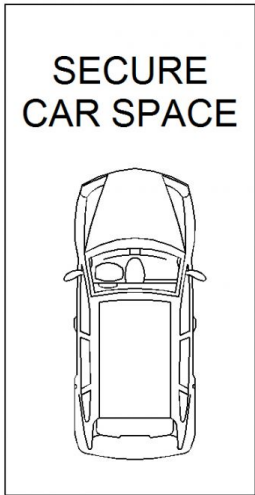

Scale shown in metres. All dimensions herein are approximate and gathered from sources believed to be reliable. Whilst every effort is made for the accuracy of our floor plans, interested parties should rely on their own enquiries. Floor Plans by Industrie Media | [industriemedia.tv](http://industriemedia.tv)

S1

513/380 Harris Street, Pyrmont

**shearer**  
property