



## G1517/780 Bourke Street Redfern NSW

1 1 1

This apartment is perched high on the fifteenth floor of the sought after Grosvenor building located within the Moore Park Gardens precinct designed by Allan, Jack and Cottier . With a stunning northerly aspect, the panoramic city views are to be envied.

**View** : <https://www.shearerproperty.com.au/sale/nsw/ea-stern-suburbs/redfern/residential/apartment/5823298>

This exceptional, split level apartment offers an open plan living area opening to a north facing balcony for easy entertaining.

### Features Include:

- . Private sunny balcony with amazing City views
- . Separation between bedroom and living area
- . Modern bathroom, internal laundry
- . Modern kitchen with dishwasher, gas cooking
- . Total area of 80sqm. Including car space
- . North/south breeze cooling the apartment through the



**Sue Shearer**  
02 9310 1801

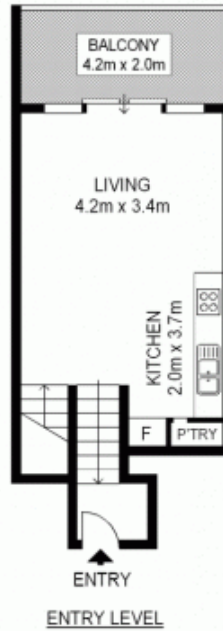

Scale shown in metres. All dimensions herein are approximate and gathered from sources believed to be reliable. Whilst every effort is made for the accuracy of our floor plans, interested parties should rely on their own enquiries. Floor Plans by Industrie Media | industriemedia.tv



G1517/780 Bourke Street, Redfern